

KAWASAKI NINJA 650 '17 - '19

M O U N T I N G I N S T R U C T I O N S

REF 3835

SPOILER DOWNFORCE



| ID | PIEZA/PART | DESCRIPCIÓN | DESCRIPTION | QTY | REF |
|----|------------|--|---|-----|-----------------|
| 1 | | Base alerón derecha | Right main plain spoiler | 1 | 10622 |
| 2 | | Winglet azul/negro/rojo/naranja/verde derecho | Right blue/black/red/orange/green winglet | 1 | 3692N/A/R/T/V |
| 3 | | Base alerón izquierda | Left main plain spoiler | 1 | 10622 |
| 4 | | Winglet azul/negro/rojo/naranja/verde izquierdo | Left blue/black/red/orange/green winglet | 1 | 3692N/A/R/T/V |
| 5 | | Soporte metálico derecho | Right metal suport | 1 | SOPOR2P3-R-3835 |
| 6 | | Soporte metálico izquierdo | Left metal suport | 1 | SOPOR2P3-L-3835 |
| 7 | | Tuerca autoblocante M4 | M4 Locking nut | 4 | TUERCAE985-0290 |
| 8 | | Arandela de goma Ø4,5 x Ø11 x 2mm | Ø4,5 x Ø11 x 2mm Rubber washer | 4 | ARAND-EPDM--722 |
| 9 | | Arandela de nylon M4x0,5 | M4x0,5 nylon washer | 8 | ARNV00000000311 |
| 10 | | Tornillo M4x12 Ø9 ISO 7380 | M4x12 Ø9 ISO 7380 Allen screw | 4 | TORNI-I7380-800 |
| 11 | | Tuerca grafilada M5 | M5 DIN6923 Nut | 2 | TUERC-D6923-255 |
| 12 | | Casquillo Ø13x Ø8 x6 | Ø13x Ø8 x6 Arrowhead | 2 | CASQUI-----776 |
| 13 | | Tornillo Allen M5x20 Ø11 ISO 7380 | M5x20 Ø11 ISO 7380 Allen screw | 2 | TORNI-I7380_730 |
| 14 | | Tapón tornillo M5 ISO 7380 | M5 ISO 7380 Allen screw cap | 4 | TAPON-----85 |
| 15 | | Arandela de nylon M5x1 | M5x1 Nylon washer | 4 | ARNV00000000245 |
| 16 | | Tornillo Allen M5x11 Ø11 ISO 7380 | M5x11 Ø11 ISO 7380 Allen screw | 4 | TORNI-AI----520 |
| 17 | | Tornillo Allen M5x16 Ø11 ISO 7380 | M5x16 Ø11 ISO 7380 Allen screw | 2 | TORNIA-7380-493 |
| 18 | | Tornillo especial M5x17 Long Hexagonal 20 | M5x17 special screw Hexagonal length 20 | 2 | TORNI-EM5---664 |
| 19 | | Espuma adhesiva protectora (10x15mm) (se suministra montada) | Protective adhesive foam (10x15mm) (supplied assembled) | 4 | ESPUMA-----264 |

KAWASAKI NINJA 650 '17 - '19

INSTRUCCIONES DE MONTAJE - MOUNTING INSTRUCTIONS - MONTAGEANLEITUNG

1

DISASSEMBLY
DESMONTAJE

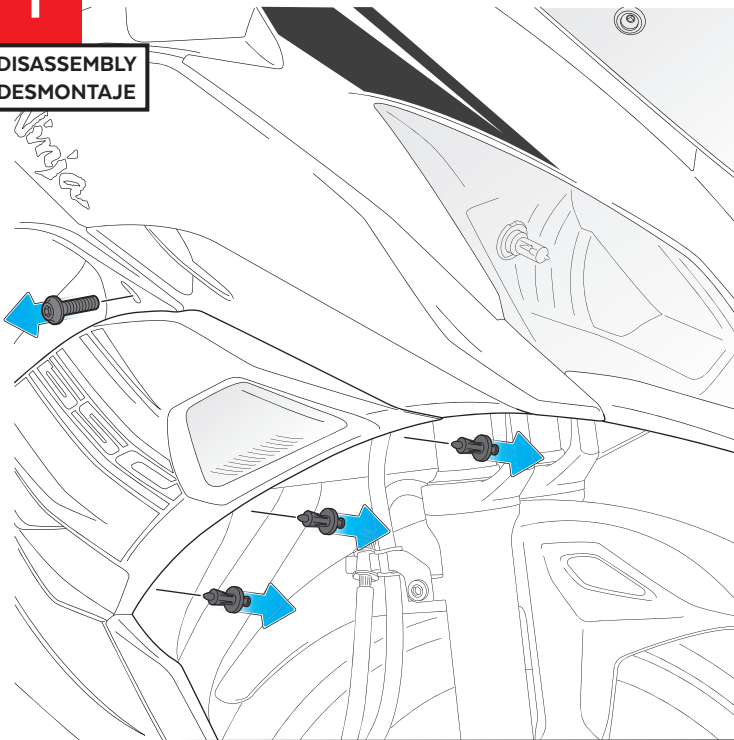

Se muestra el montaje del lado derecho a modo de ejemplo, realizar los mismos pasos para el montaje del lado izquierdo.
The right side assembly is shown as an example, so the same steps can be performed for the left side assembly.

2

DISASSEMBLY
DESMONTAJE

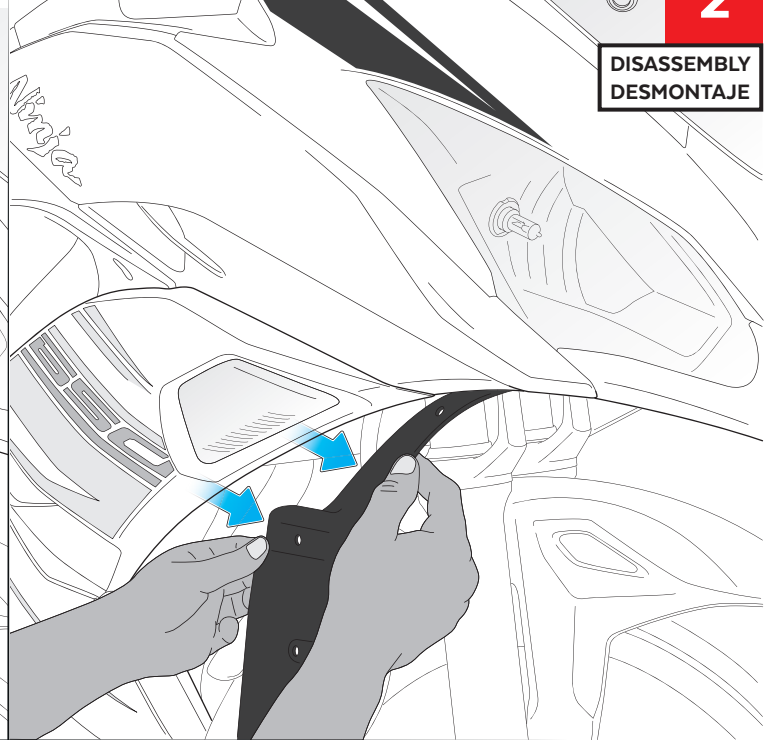

3

ASSEMBLY
MONTAJE

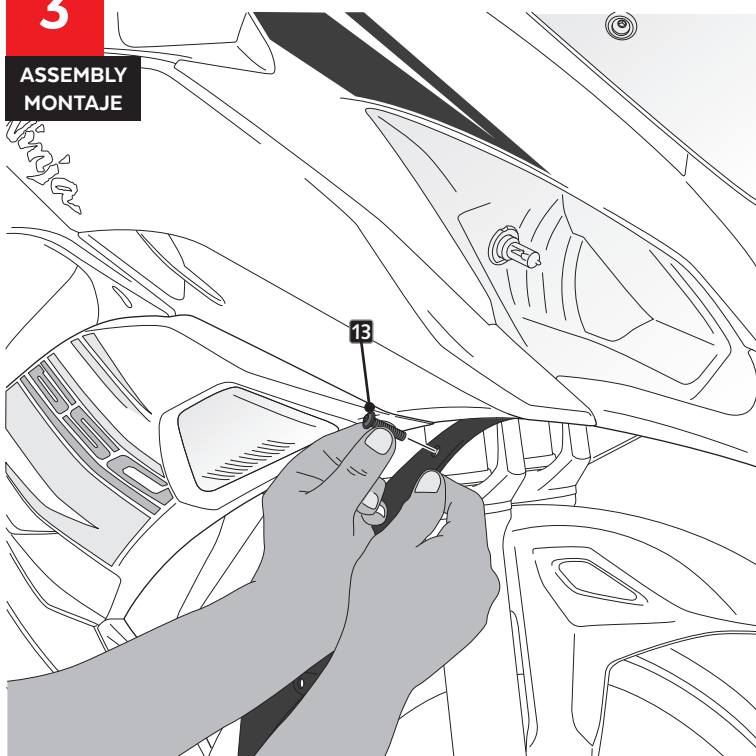

4

ASSEMBLY
MONTAJE

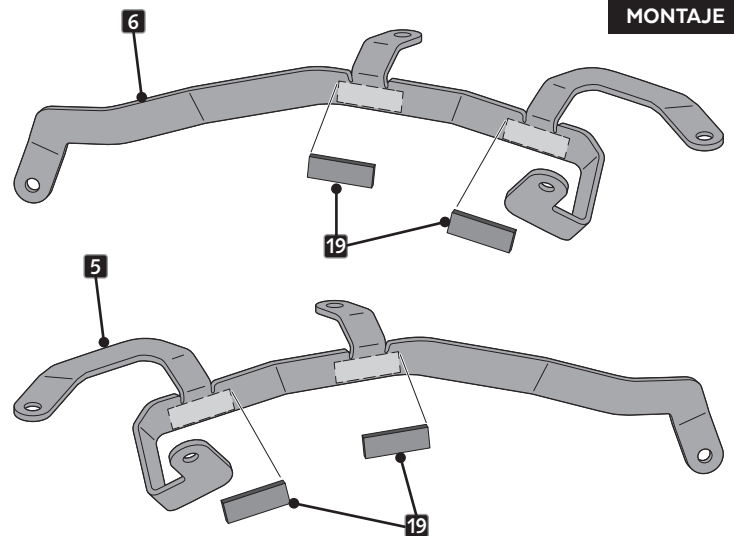

KAWASAKI NINJA 650 '17 - '19

INSTRUCCIONES DE MONTAJE - MOUNTING INSTRUCTIONS - MONTAGEANLEITUNG

5

ASSEMBLY
MONTAJE

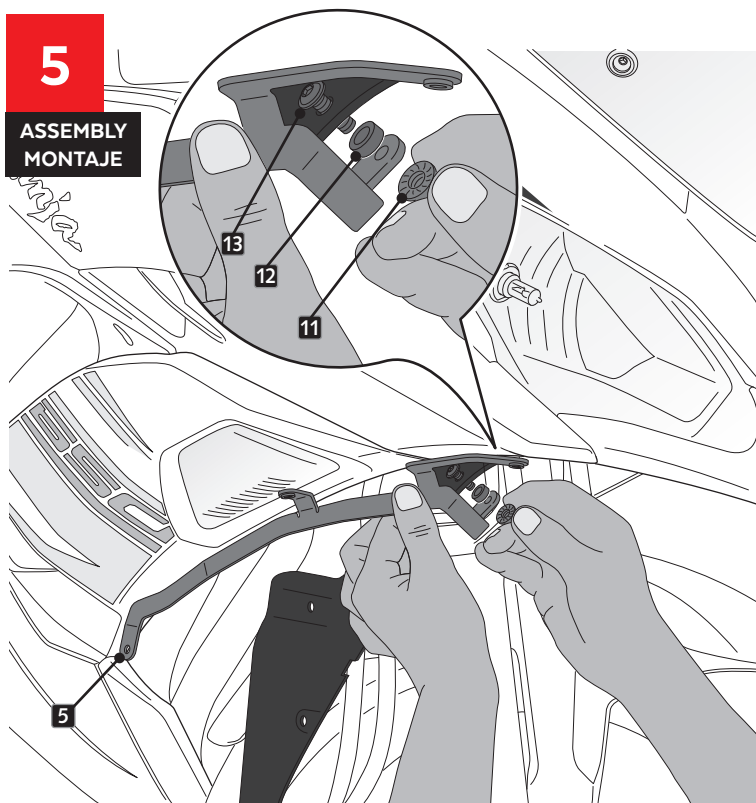

6

ASSEMBLY
MONTAJE

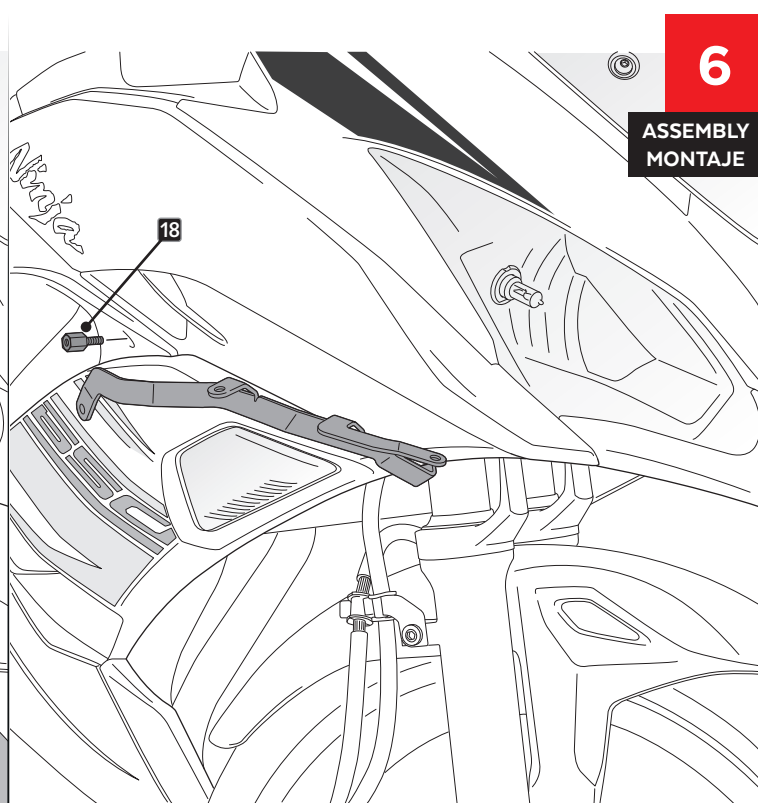

7

ASSEMBLY
MONTAJE

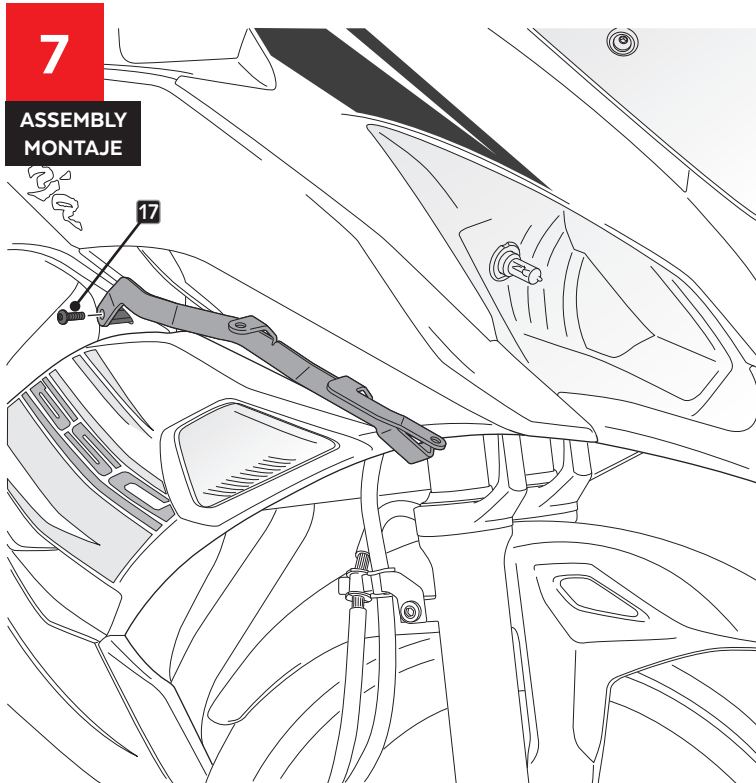

8

ASSEMBLY
MONTAJE

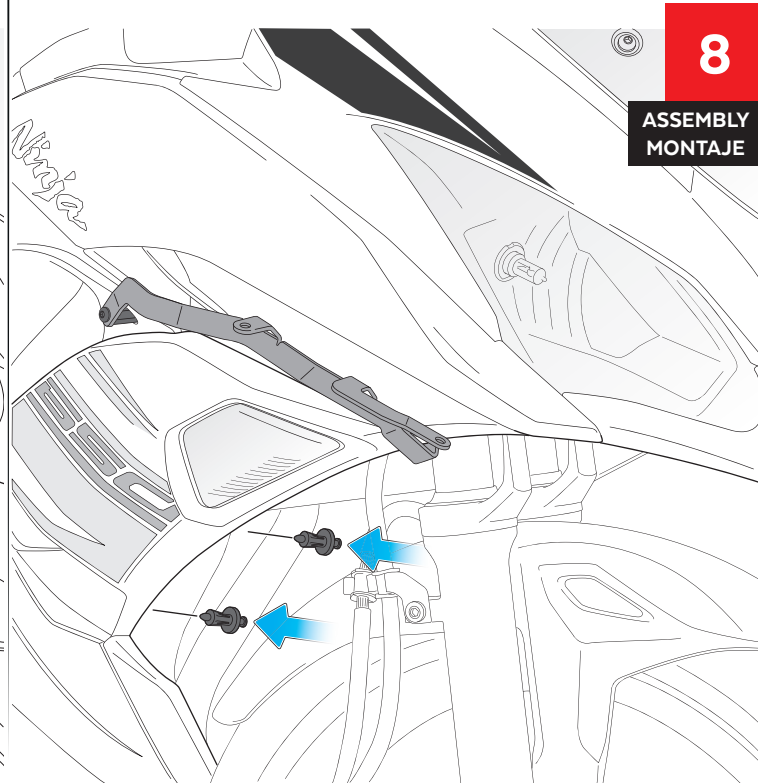

KAWASAKI NINJA 650 '17 - '19

INSTRUCCIONES DE MONTAJE - MOUNTING INSTRUCTIONS - MONTAGEANLEITUNG

9

ASSEMBLY
MONTAJE

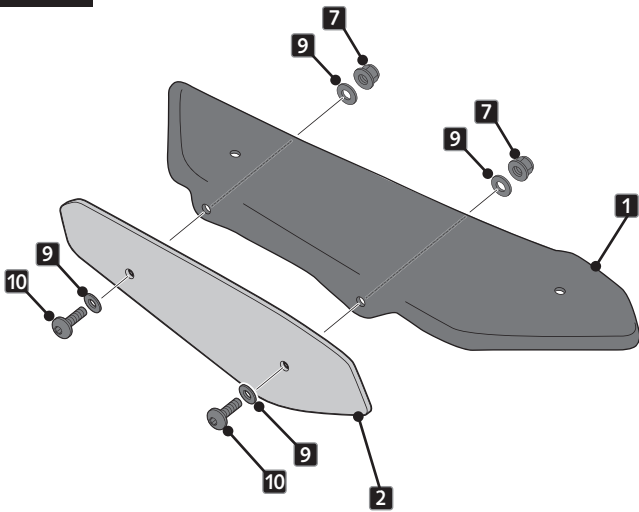

10

ASSEMBLY
MONTAJE

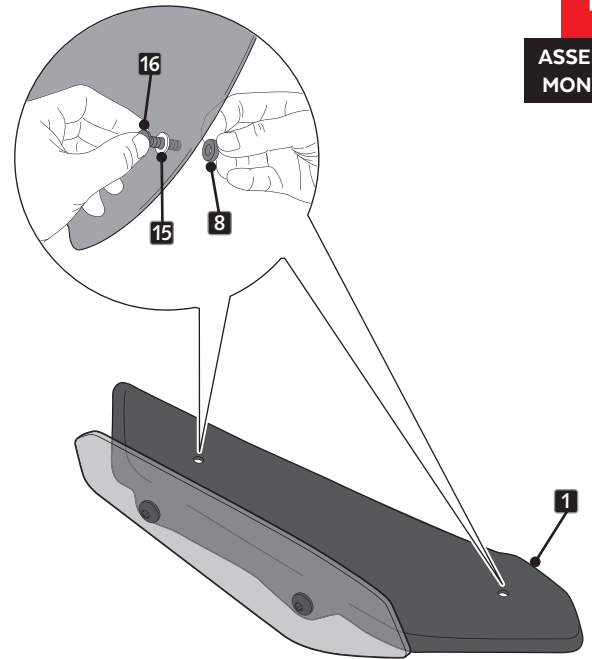

11

ASSEMBLY
MONTAJE

