

HONDA CBR1000RR FIREBLADE / SP '20-

MOUNTING INSTRUCTIONS

VIDEO

REF 20508

FRONTAL GP SPOILER / ALERON FRONTAL GP



1 Person



15 min



EASY

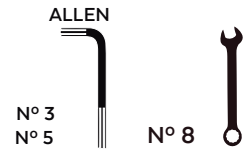

ID.	PIEZA/PART	DESCRIPCIÓN	DESCRIPTION	QTY.	REF.:
1		Base alerón (ABS)	Main spoiler (ABS)	1	10850JM3
2		Soporte metálico	Metal support	1	SOPORIP3--20508
3		Pieza soporte alerón (Tamaño pequeño)	Spoiler support piece (small size)	2	SOPOR-I---20431
4		Deflector derecho	Right deflector	1	10851A/N/RM3
5		Deflector izquierdo	Left deflector	1	10851A/N/RM3
6		Tapon tornillo M5 DIN7991	M5 DIN7991 screw cap	8	TAPON-----92
7		Tornillo allen M5x30 Ø11 ISO 7380	M5x30 Ø11 ISO 7380 allen screw	4	TORNI-I7380-767
8		Casquillo Ø13xØ8,5x9mm	Ø13xØ8,5x9mm arrowhead	4	CASQUI-----777
9		Tornillo M5x16 DIN7991 (negro)	M5x16 DIN7991 screw (black)	4	TORNI-D7991-867
10		Tornillo M5x12 DIN7991 (Negro)	M5x12 DIN7991 screw (black)	4	TORNI-D7991-611
11		Tuerca autoblocante M5	M5 lock Nut	4	TUERCA-D982-746
12		Arandela de goma Ø4,5xØ11x2mm	Ø4,5xØ11x2mm rubber washer	8	ARAND-EPDM--722
13		Tope de goma Ø3,7-3,8x3,2mm	Ø3,7-3,8x3,2mm bumper foot	4	TOPE--POF-40022
14		Arandela de nylon M5	M5 nylon washer	4	ARNV0000000245
15		Plantilla	Template	1	PLANT-----20508
16		Lápiz AP1111 Adhesion promoter	AP1111 adhesion promoter Pen	1	KITNETEJA-----

HONDA CBR1000RR FIREBLADE / SP '20-

INSTRUCCIONES DE MONTAJE - MOUNTING INSTRUCTIONS - MONTAGEANLEITUNG

1

**DISASSEMBLY
DESMONTAJE**

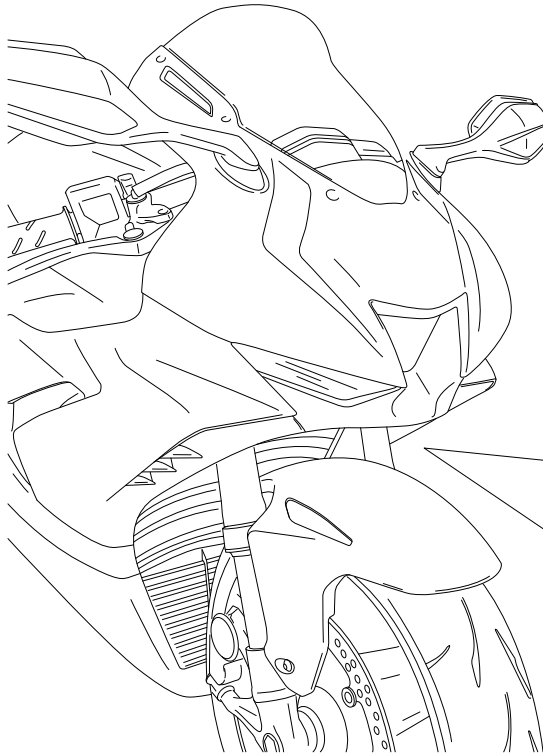

A Tornillo original
Original screw

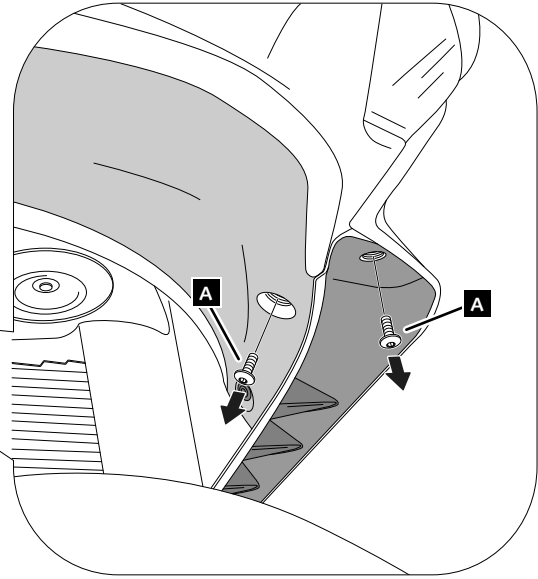

2

**ASSEMBLY
MONTAJE**

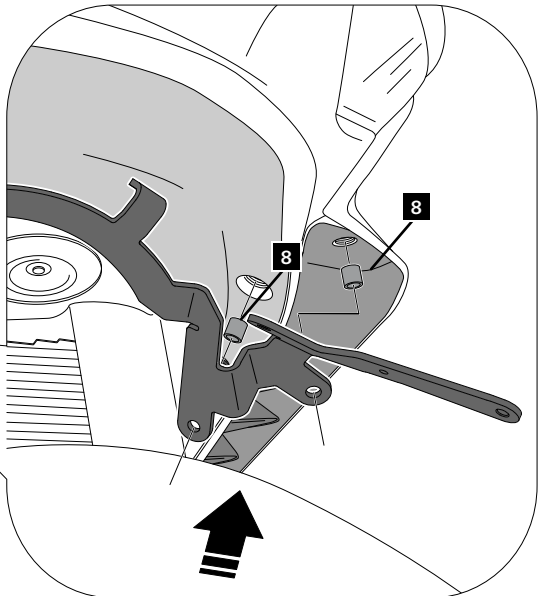
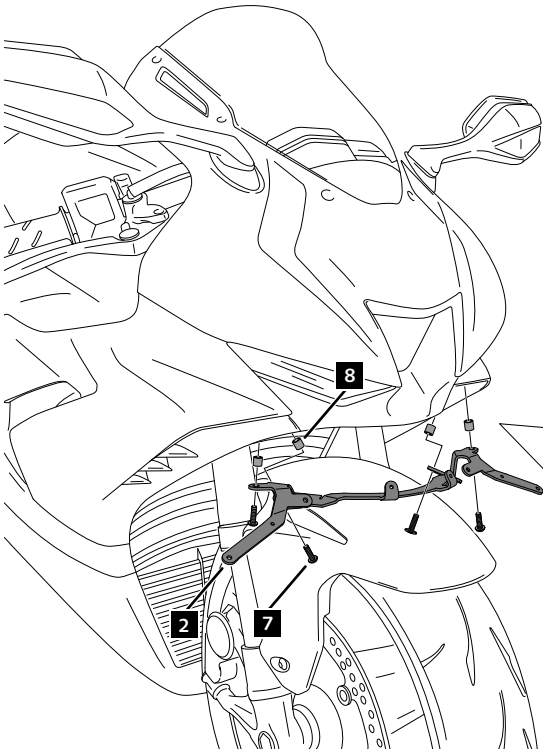

HONDA CBR1000RR FIREBLADE / SP '20-

INSTRUCCIONES DE MONTAJE - MOUNTING INSTRUCTIONS - MONTAGEANLEITUNG

3

ASSEMBLY
MONTAJE

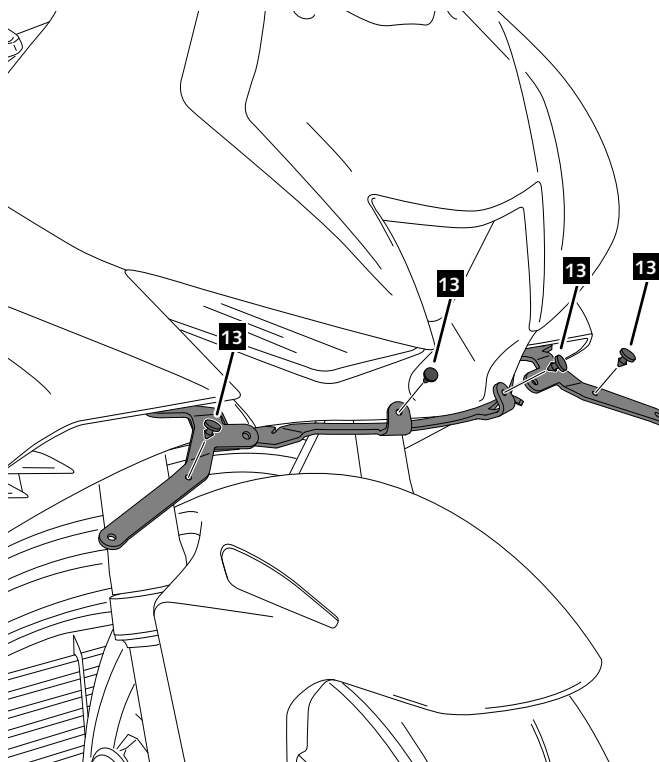

4

ASSEMBLY
MONTAJE

CLEAN THE SURFACE
WITH NATURAL SOAP.



PRESS HARD THE PEN ID16
UNTIL THE GLASS INSIDE
BREAKS AND
THE FLUID FLOWS



16

APPLY THE PEN
ONLY ON SPOILER
SUPPORT PIECE
AREA.



CHECK IS COMPLETELY DRY
BEFORE START.

Se muestra el montaje del lado derecho a modo de ejemplo,
realizar los mismos pasos para el montaje del lado izquierdo.
The right side assembly is shown as an example, so the
same steps can be performed for the left side assembly.

15 Use the same template for the left
and right side

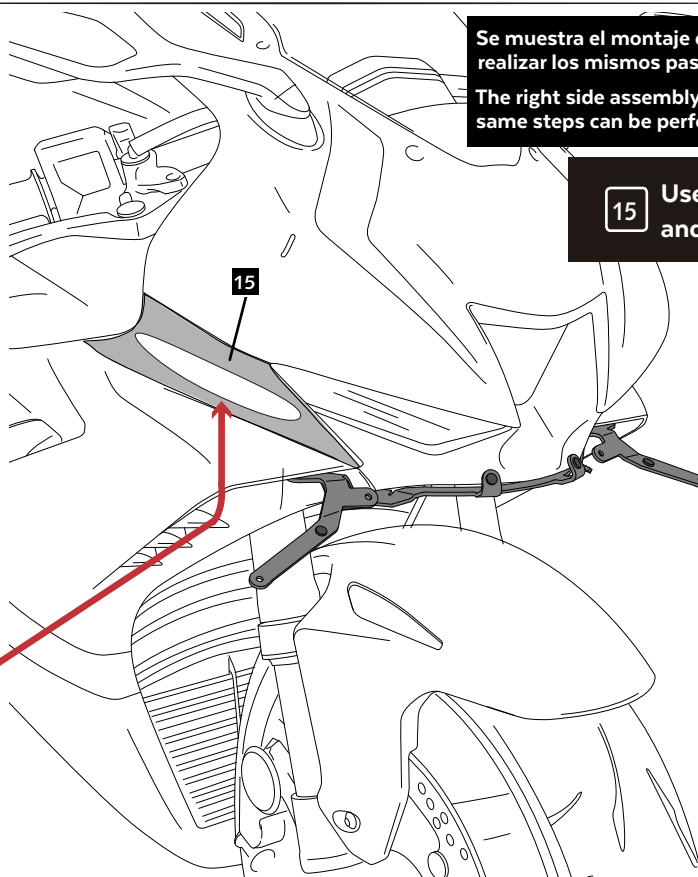

HONDA CBR1000RR FIREBLADE / SP '20-

INSTRUCCIONES DE MONTAJE - MOUNTING INSTRUCTIONS - MONTAGEANLEITUNG

5

ASSEMBLY
MONTAJE

5.1 DOBLAR LOS EXTREMOS DE LA PIEZA
FOLD THE ENDS OF THE PIECE

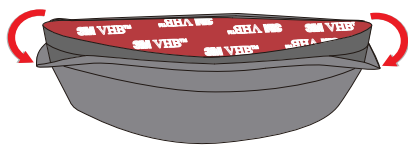

5.2 EXTRAER PAPEL DEL ADHESIVO 3M
REMOVE PAPER FROM 3M ADHESIVE

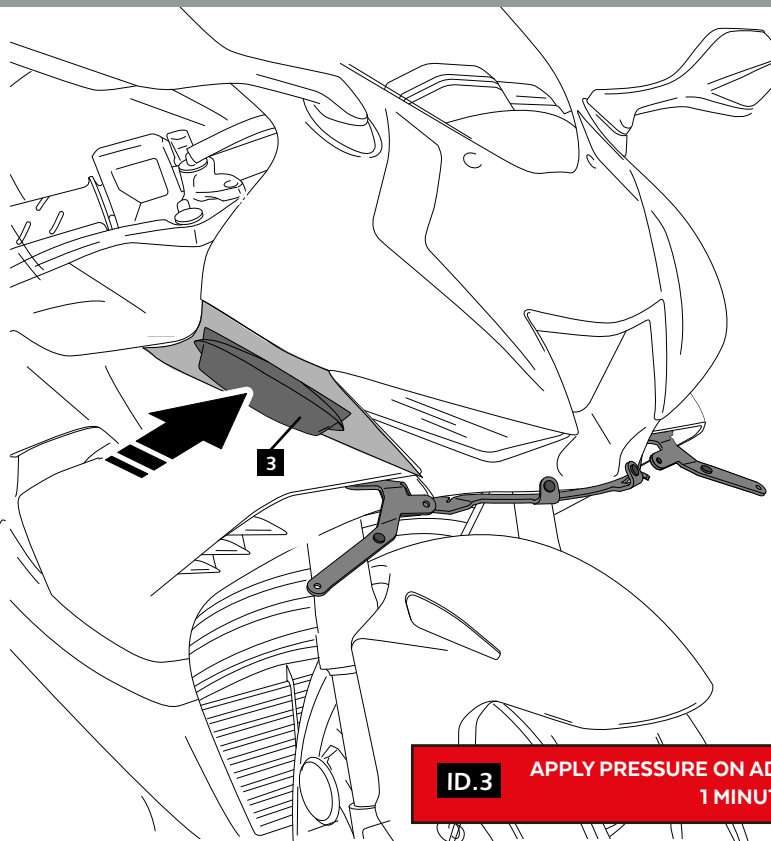
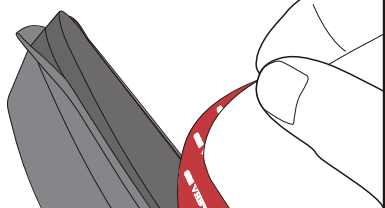

ID.3

APPLY PRESSURE ON ADHESIVE AREA FOR
1 MINUT

6

ASSEMBLY
MONTAJE

WAIT 24 HOURS



CHECK THE CORRECT ADHESION
OF THE 3M DOUBLE SIDE
SELF-ADHESIVE TAPE
TO THE FAIRING. ENSURE THAT
THE ENTIRE SURFACE
IS WELL ADHERED

HONDA CBR1000RR FIREBLADE / SP '20-

INSTRUCCIONES DE MONTAJE - MOUNTING INSTRUCTIONS - MONTAGEANLEITUNG

7

ASSEMBLY
MONTAJE

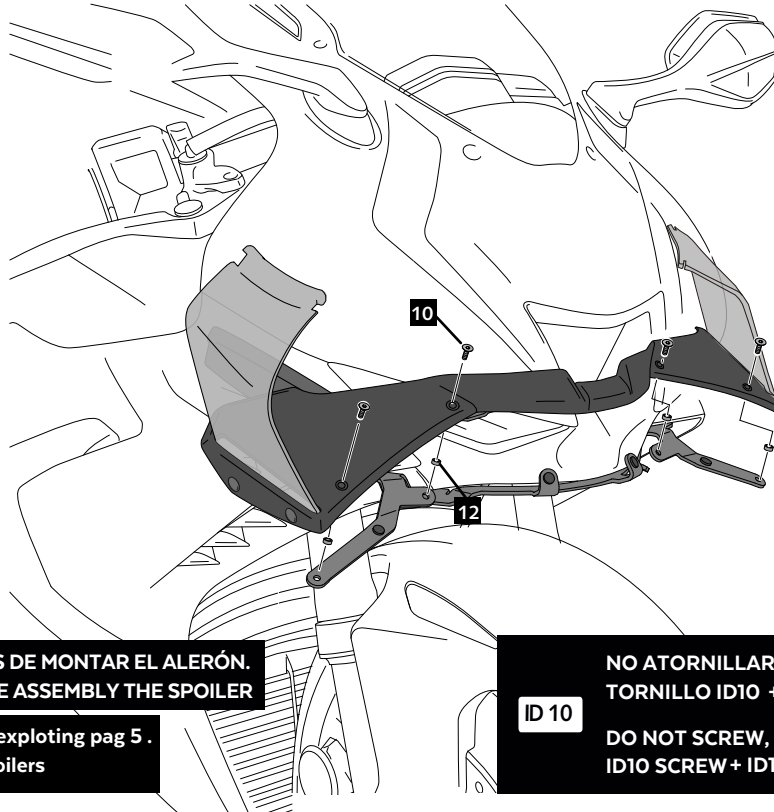

EXTRAER PLANTILLA ANTES DE MONTAR EL ALERÓN.
REMOVE TEMPLATE BEFORE ASSEMBLY THE SPOILER

NO ATORNILLAR, SÓLO REALIZAR PREMONTAJE:
TORNILLO ID10 + ARANDELA GOMA ID12



Para montaje alerones ver exploding pag 5 .
See page 5 to assembly spoilers

ID 10

DO NOT SCREW, ONLY PERFORM PRE-ASSEMBLY:
ID10 SCREW + ID12 RUBBER WASHER

8

ASSEMBLY
MONTAJE

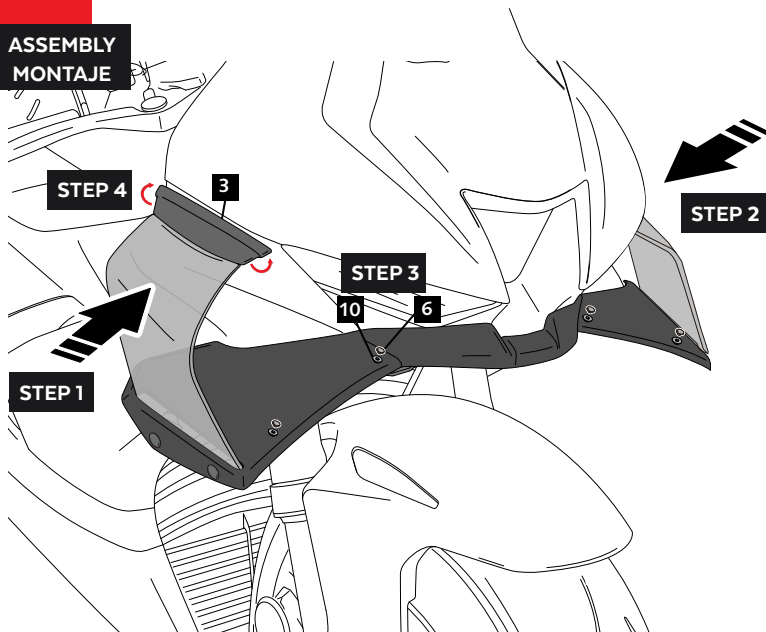

STEP 3

TIGHTEN ID.10 SCREWS
APRETAR TORNILLOS ID.10

EXPLOTING
DESPIECE

